

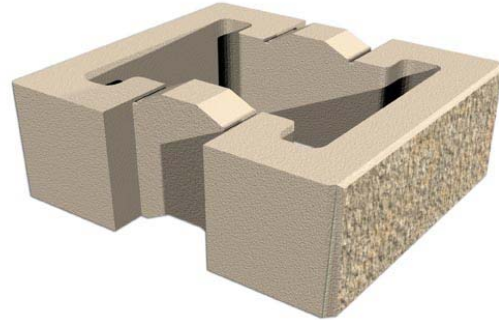

AB Fence Tech Sheet

AB Fence Large Post Block

The AB Fence Large Post Block functions the exactly the same way as the AB Fence Standard Post Block, it transfers the laterally applied wind loads to the fence foundation system. The large post block is the same length as the standard post block but the width jumps from 12 inches to 20 inches. This larger width increases the design depth by 100%.



Another benefit is the larger core. This allows the designer to call for larger diameter reinforcing bars or even multiple rows of reinforcing. The large post block is used for those projects where either the total height or wind loads exceeds the capacity of the standard post block. In addition, to accommodate the overall size of the large post block, the pile diameter should be increased from 24" (610 mm) minimum to 30" (762 mm) minimum.

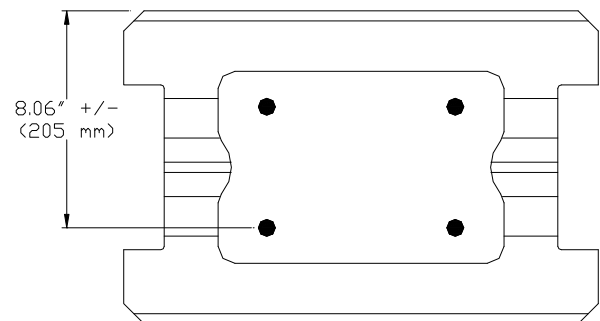
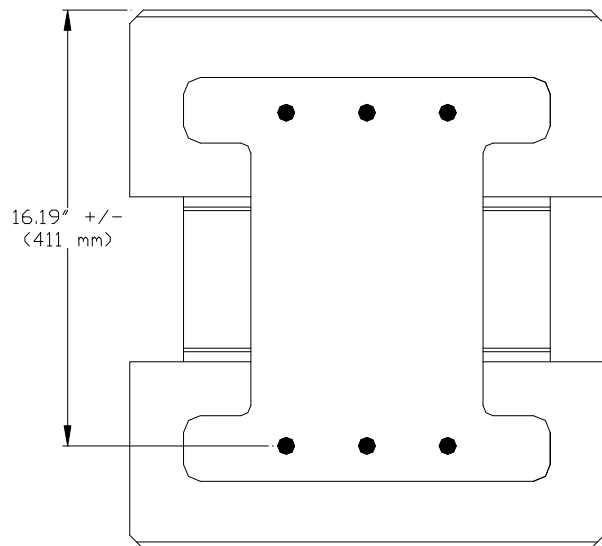

Spacer Jig

The AB Fence system is a modular system made up of individual panel and post blocks. The panels are constructed by stacking multiple panel blocks in rows to form each course. This modular nature of the system makes the post spacing dependent on the length of the assembled parts. Before any post footings are dug the contractor must be aware of the exact length of the designed post spacing. The spacer jig shown below is similar to that of a standard post block. It can be used to help locate the piles and pile/column steel in the correct locations. If the post spacing's are not located correctly, the contractor will be required to modify the panel length by cutting each course of panel block.

